

*Privilege*

M A R I N E

Since 1985



The cruise... custom made

PRIVILEGE

745

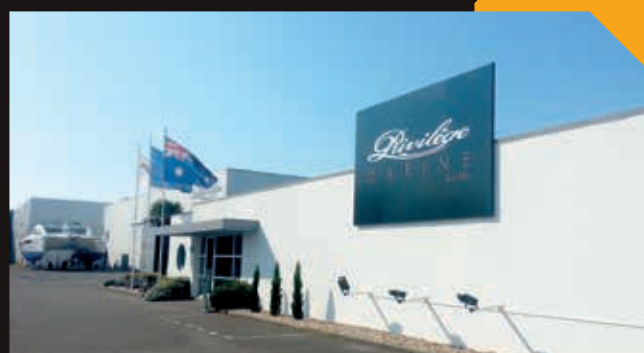
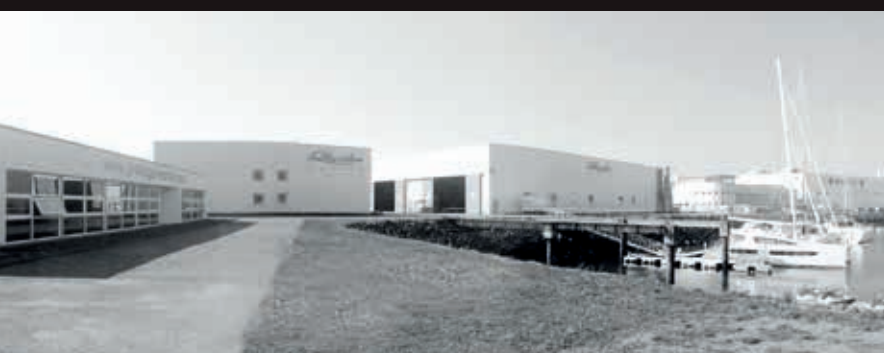

# Privilege

## M A R I N E

Since 1985

**Since 1985, PRIVILEGE cruising catamarans have enjoyed a worldwide reputation for their high-end position on the multihull market.**

The very first one was conceived and designed by the double world champion solo racer and founder of the Vendée Globe, Philippe Jeantot.

He has placed his entire experience in sailing around the world at the service of PRIVILEGE yachts, by defining a list of specifications of which the fundamental criteria of navigation are: safety, comfort, reliability and pleasure of navigation.

Since then, no fewer than 600 PRIVILEGE yachts, of lengths ranging from 12 to 23 m, including 80 units over 17 meters, have sailed all over the world.

### **The PRIVILEGE 745 inherits historic know-how and the best manufacturing process.**

The hull, the nacelle (main pod), and the deck are fully vacuum infused on a strong base of glass / vinylester sandwich.

The internal structure is made up entirely of transversal and longitudinal vacuum sandwich bulkheads, directly stratified to the hull and the deck.

Strength and lightness are ensured, whilst allowing some flexibility (needed by the forces applied during offshore navigation).

The necessary monolithic areas and the various reinforcements are also built by vacuum infusion. A vinylester anti-osmosis barrier is applied to the whole structure.

In complement to the usual EC certification, the famous survey office **BUREAU VERITAS** has been hired by the shipyard, on a yearly basis, in order to control and certify each unit built; the requirements are strict and not negociable.

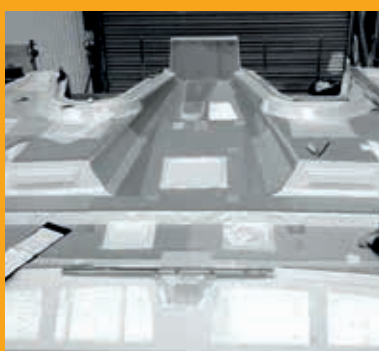



# A timeless model

The PRIVILEGE 745 is born in 2006 and stays today up to the speed of the market; sharp and modern exterior lines, refined and decorated with care. Six units are sailing all over the world, and each one is unique with special features. This is the leitmotiv of Privilège Marine on this model: to make possible every demand of customization.



## Meet 6 outstanding PRIVILEGE 745

Each owner has been part of the decisions in layout, equipment, finishings, ...



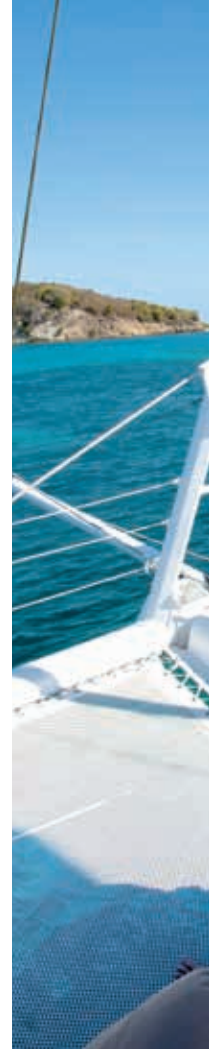



# *Crew*

## “MATAU” Comfort and wellbeing

“MATAU” is dedicated to high class charter, sailing in the warm waters of the Caribbean, with her loyal and passionate crew. As a result, the service on board is luxurious, the menus delicate and the souvenir remains unforgettable.

She provides a comfort comparable to large yachts, with 4 double VIP cabins, with private heads, including a spacious owner cabin with bubble bath. The glossy finish maple wood interior contrasted with the dark wenge floor offer a zen atmosphere, invite you to relax.

The actual owner has already a PRIVILEGE 65, the choice of the 745 was a natural development.

**Wellbeing of the crew: Definitely a criteria of loyalty and quality of service.**

The crew quarters are fully independent. Accessible from the galley, and finished in the same standards, they can welcome 4 persons, with a private salon area. Privacy of guests onboard involves a discreet and relaxed crew ...





# “CAPTIVA”

## At your beck and call



For his fourth PRIVILEGE, the owner of Captiva was actively involved in the specifications of his yacht for a life on board program; to greet his friends and children, to enjoy stopovers in Monaco or Tortola, always good reasons to travel the world.

Classic, with cherry wood and alcantara, Captiva offers a central amazing owner cabin with special access directly from the salon, and three spacious guests cabins. What a substantial aesthetic achievement! The bar custom made, the lounging area, the full design, make her as a typical PRIVILEGE, classic and elegant!

### **The word from the naval architect, Marc Lombard**

*“For most of the PRIVILEGE 745, some degree of customization of the structure is essential. When owner’s wishes are possible and compatible with the reliability of the entire structure, we respond as best as we can. In all cases, we preserve rigidity of the yacht and respect weight ratios, essential guarantee of performance.”*





# *Custom*

## “CLARA MARIS” Custom made...

Usually, each yacht is the achievement of a dream, a project, prepared with fever and care, shared with family members for finally matching as effectively as possible to your image.

Clara Maris has been designed in every detail by her owners.

The very spacious cockpit welcomes you under a large glass hardtop, hand-made, fully illuminated, with the arms of the family.

Inside, the salon is amazingly huge, thanks to her clean interior with bright glossy maple, cream alcantara and leather; you are invited to relax on a great king size day bed, designed in round shapes.

In hulls, an efficient and practical layout organizes the crew quarters, two double Guests cabins and a unique owner suite fully separate: private office with all working facilities, allowing you to remain active and always connected, while changing horizon when you decide.





# “LADY ALLIAURA”

## Life's sweetness

PRIVILEGE catamarans have always been designed for allowing safe cruising in optimal conditions:

- > **Ergonomic central helm steering at fly:** optimized for being well protected during heavy weather, the panoramic view on the full deck is great and makes sailing easy and safe (backup cameras for aft vision).
- > **Simple and efficient deck layout:** properly dimensioned, the rigging is secure and reliable, sheets and halyards are constantly visible, all winches are electric, stainless steel is premium grade quality.
- > **A spacious fly bridge:** a large spiral staircase offers easy access to the fly bridge ; the big size teak table, large benches and sunbeds, bar and music, all is done for relaxing.
- > **The main central pod forward:** easy and safe access to the mast and to the electric windlass. Everyone can refresh while lounging on the two forward nets or sitting on the strong st/steel teak pulpits.
- > **The wide catwalks:** the solid st/steel hard guardrails ensure total security on board.
- > **The friendly cockpit** is really huge, well protected by an illuminated hard top, and can be arranged as per your needs : bar, double benches, several tables ...
- > **The two aft swim platforms** invite to authentic pleasures : swimming, fishing, water skiing or diving...
- > **The tender** (15' long) is sitting on a wide teak platform (in option) and is handled easily via the telescopic lifting crane, stored in the aft beam.







# “LADY ALLIAURA II”

## Refinement and serenity

The shipyard has always pointed out its very exclusive signature: **the main central pod (rostrum)**.

> Forwards of the mast, this structural volume offers a significant and **unique living space**, above the water, receiving especially the owner cabin.

> It offers a **better mechanical resistance**, in reinforcing the rigidity of the entire longitudinal structure of the yacht, and in releasing the different compressive forces of forestay on the main nacelle.

> The **comfort is optimised** and enables movement on a stable surface in complete safety, especially by heavy weather, by limiting the sprays and reducing the plunge into the sea.

> **A technical area** is really adapted for receiving the anchor locker, windlasses and sails storage.

Lady Alliaura II benefits from extra lateral windows on the central pod, for offering more visibility and light in the owner cabin.





# Alchemistry

## “CATTITUDE” In all conditions

Carbon mast (in standard), canoe boom, forward structural beam with dolphin striker are subject to very strict specifications from the builder, in order to guarantee extreme longevity.

The stability of our masts is reinforced by a lower stay fixed on the pod, as well as shrouds and low shrouds: reliability in all conditions!



For the sails, INCIDENCES, the leading brand for all sails made by piece, satisfies the specifications set up by the shipyard, with no equivalent on the market : high-tech cut, a strong roach, UV protection, 6-step zigzag sewing using specific white thread, straps and reinforcements. Even after 5 years intensive sailing, they guarantee durability and performance.

For rigging and gear, winches are in chrome-plated stainless steel and properly dimensioned for facing to strong efforts. Systematic reinforcements are fibreglassed at strategic points (cross beams, cleats, pulpits,...)



# *Exclusive* An exclusive version...

Imagine a spacious bedroom: 9 meters wide with a extra large bed of 180cm x 200cm bed, displayed in an alcove...

Silence, comfort, and refinement guaranteed.



> Owner Version « **LUXURY** » 3 CABINS + CREW

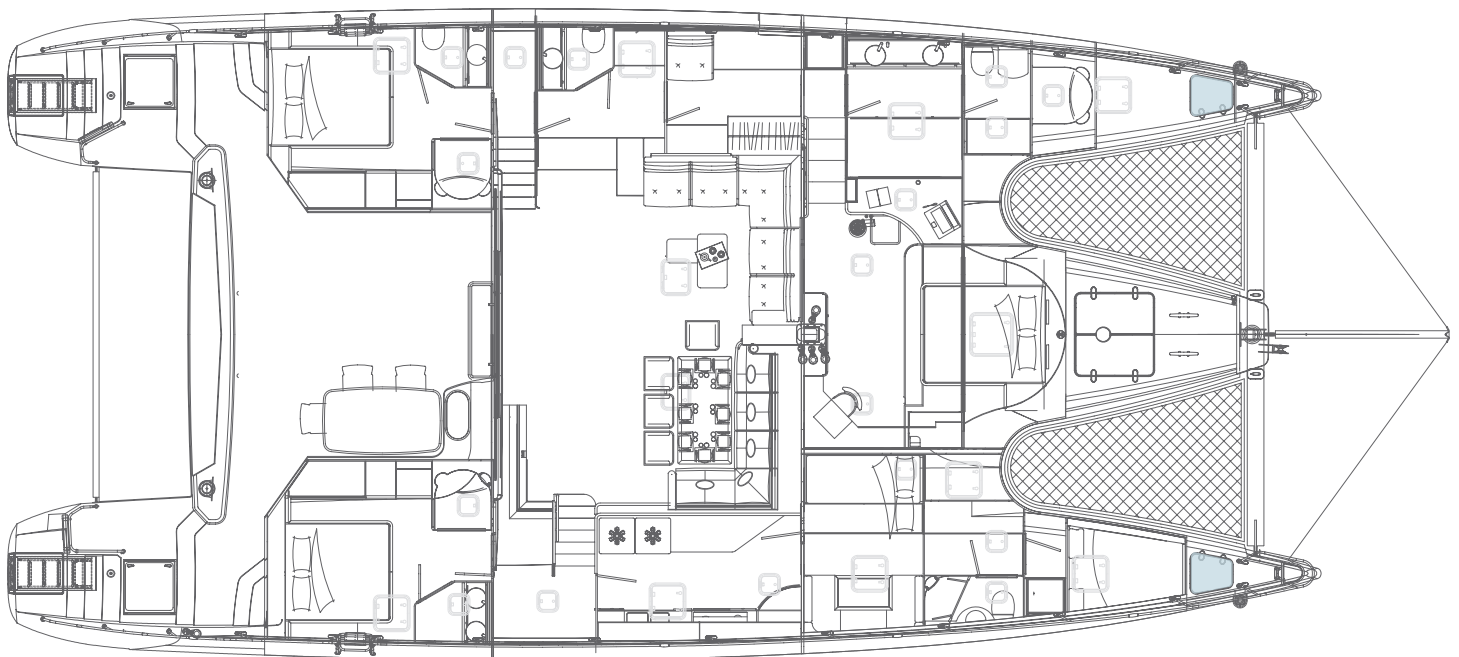
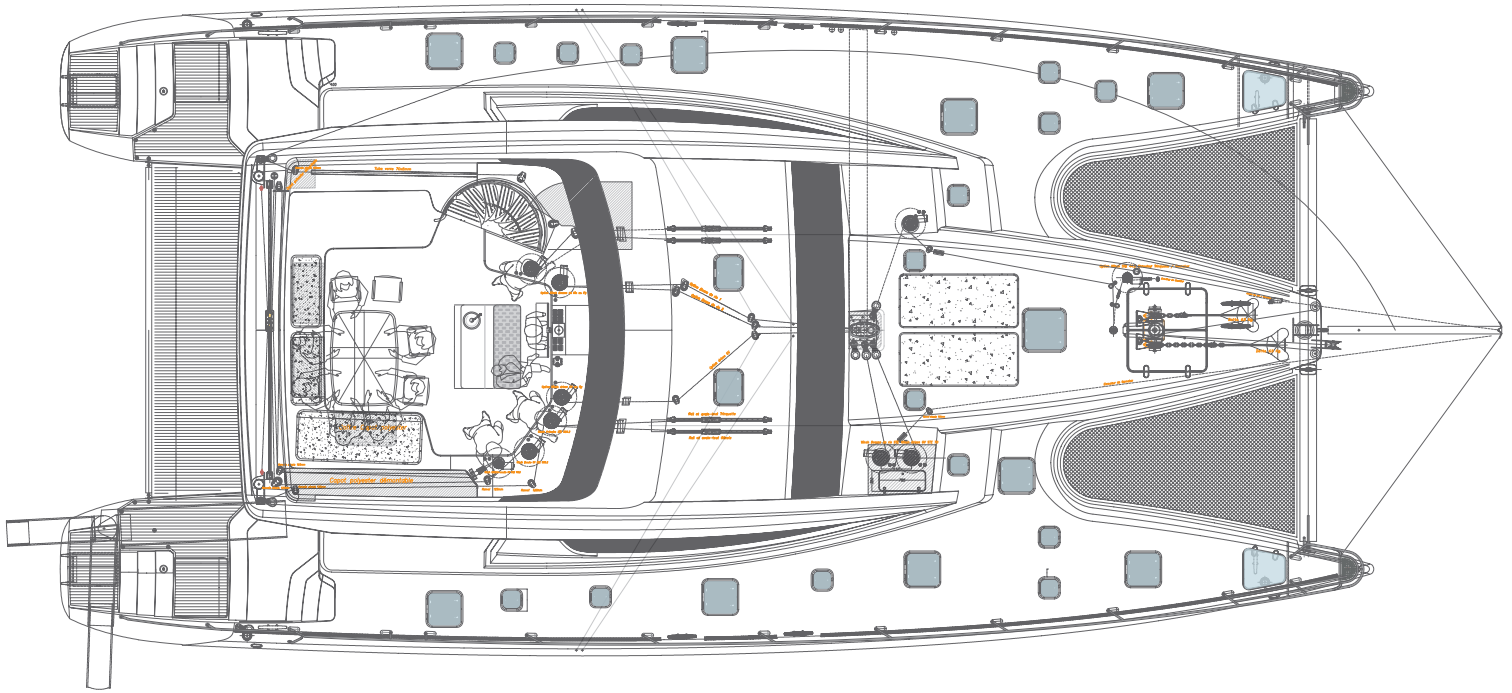





## Marc Lombard, naval architect

For over twenty years, Marc Lombard signs all the hulls of the PRIVILEGE range.

He runs the best research techniques used in competition:

- > hydrodynamic analyses using digital simulation,
- > structural calculations on composite materials,
- > analysis of weights distribution,
- > design of the hull for limiting parasitic drag from waves between the two hulls,...

In short, an expert recognized in reliability and performance optimization.

The choice of spacious hulls, with a large ratio of volume above and below waterline, guarantees comfort and safety in all seas and loading conditions any cruising catamaran has to face.

The combination of high-end manufacturing techniques and lightness of structure offers the best compromise between volume, displacement, and performance.



### Marc Lombard :

*"We have made the choice of anti drift fins which are almost as efficient as daggerboard, but without having to deal with the disadvantages. Sailing upwind on a catamaran is linked to the average efficiency of the sail more than the hydrodynamics of appendages".*



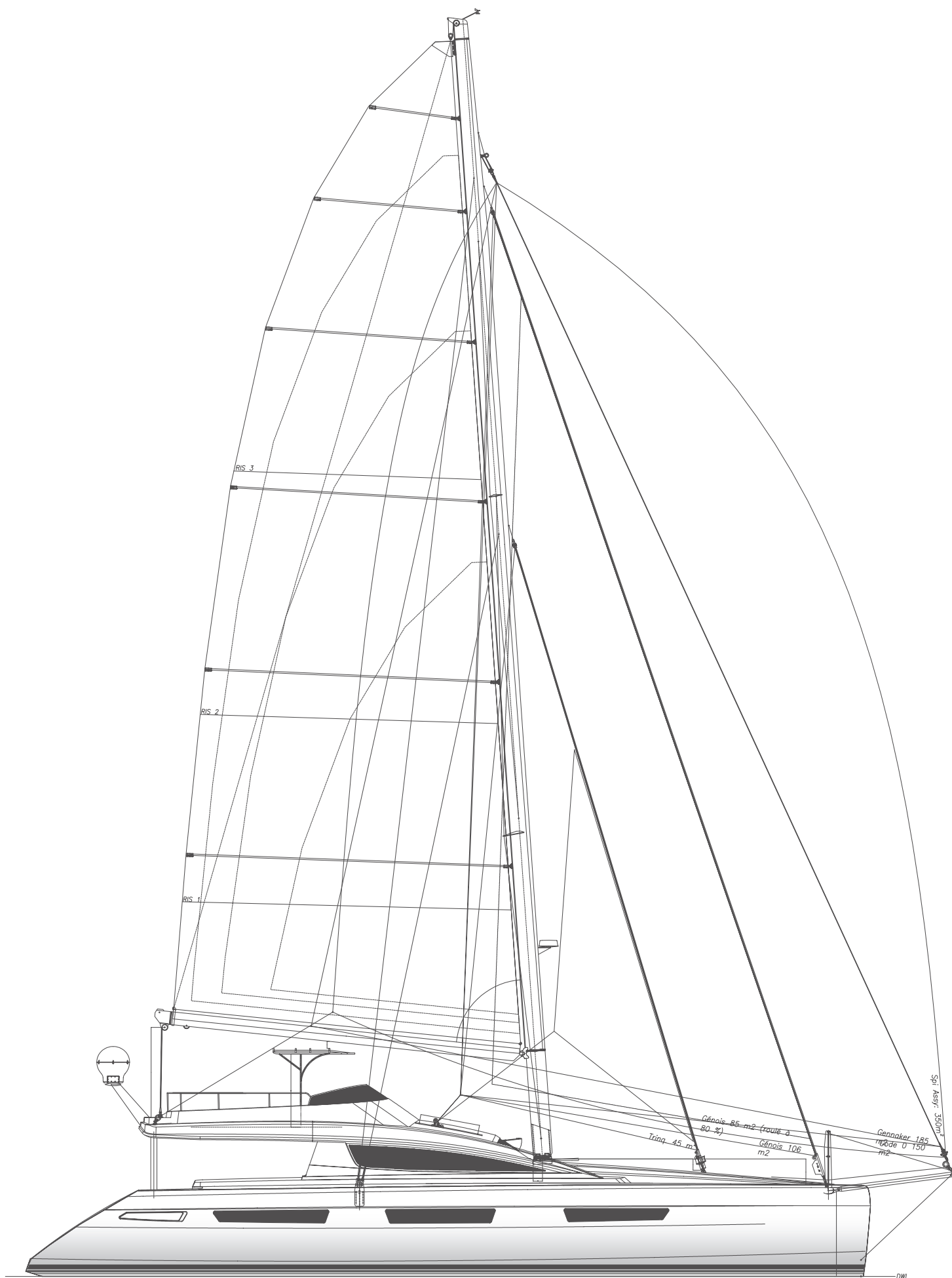

# Main specifications

Lenght overall	74'5	22,70 m
Beam	35'7	10,90 m
Draft	7'2	2,20 m
Max. airdraft	108'2	33 m
Light displacement	85 000 lbs	40 T
Diesel capacity	925 gal	3500 L
Fresh water capacity	630 gal	2400 L
Black water capacity	160 gal	600 L
Double cabins		3, 4, 5
Crew quarter		1 or 2 to 4 pers.
Engines	2 x 200 HP	2 x 200 CV

## Rigging

Mainsail	1720 sqft	160 m²
Genoa	1119 sqft	104 m²
Staysail	505 sqft	47 m²
Gennaker	2500 sqft	232 m²
Mast height	96'8	29,73 m

## Building

Naval architect

Cabinet Marc LOMBARD

Builder

Privilège Marine



*Privilege*  
M A R I N E  
Since 1985

Port Olona - Les Sables d'Olonne - France  
[www.privilege-marine.com](http://www.privilege-marine.com) - +33(0)2 51 22 22 33